

Location Plan

Sheet 1 of 10

SUBJECT TO SURVEY

This plan has been prepared to accompany the application for Strata Titling being compiled from various sources with or without field survey. The plan incorporates your stated requirements and the current by-laws or ordinances of the Council but may be subject to further design after detailed discussions on Council requirements.

The property title boundaries have been compiled from the existing survey plans lodged with the Registrar of Titles. The dimensions of these boundaries may change when a full survey is done as part of the Strata Titling process.

The plan is an indicative strata title design suitable for an application to the W.A. Planning Commission. The dimensions, areas and total number of lots shown on our proposal plan are subject to field survey and also to the requirements of Council and service authorities and the Planning Commission or other authorities which may have requirements under any relevant legislation.

The information shown on this plan is not suitable for any other purpose and we can accept no responsibility for loss or damage caused to any person who may rely on the information for a purpose for which it was not intended.

As the strata title design, lot number and dimensions may change, no reliance can be placed on this plan to assess the value of the property.

These notes form an integral part of the information and advice we are providing to you in this project.

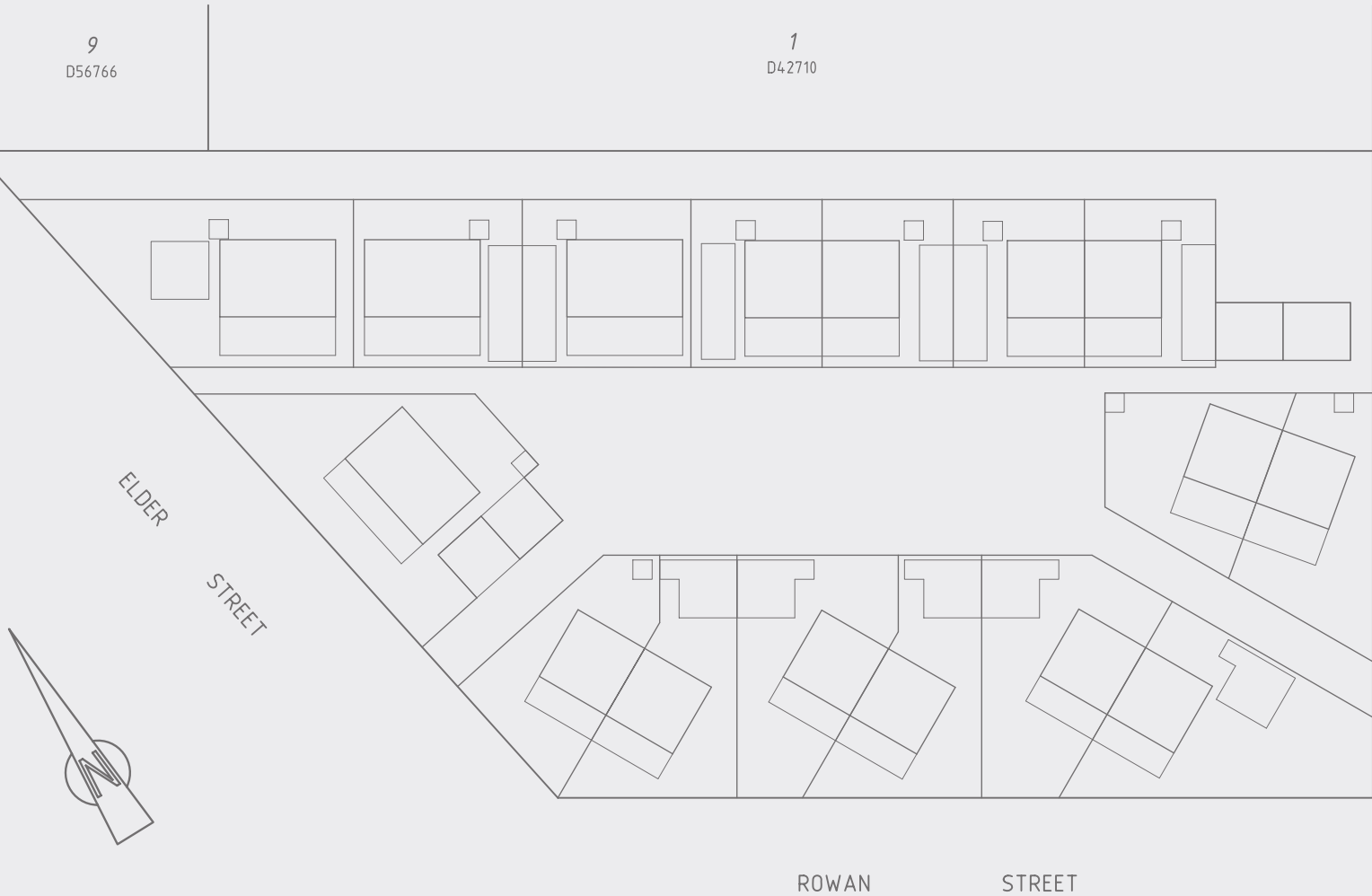

DESCRIPTION OF PARCEL AND BUILDINGS

TWELVE (12) SEMI-ATTACHED AND FOUR (4) STAND ALONE RESIDENTIAL UNITS
ALL SITUATED ON LOT 10 ELDER, ROWAN & JOHNSTON STREETS, DERBY

LOCATION PLAN

SHEET 1 OF 10 SHEET